

Island Cemetery

Newport, Rhode Island

July 2023

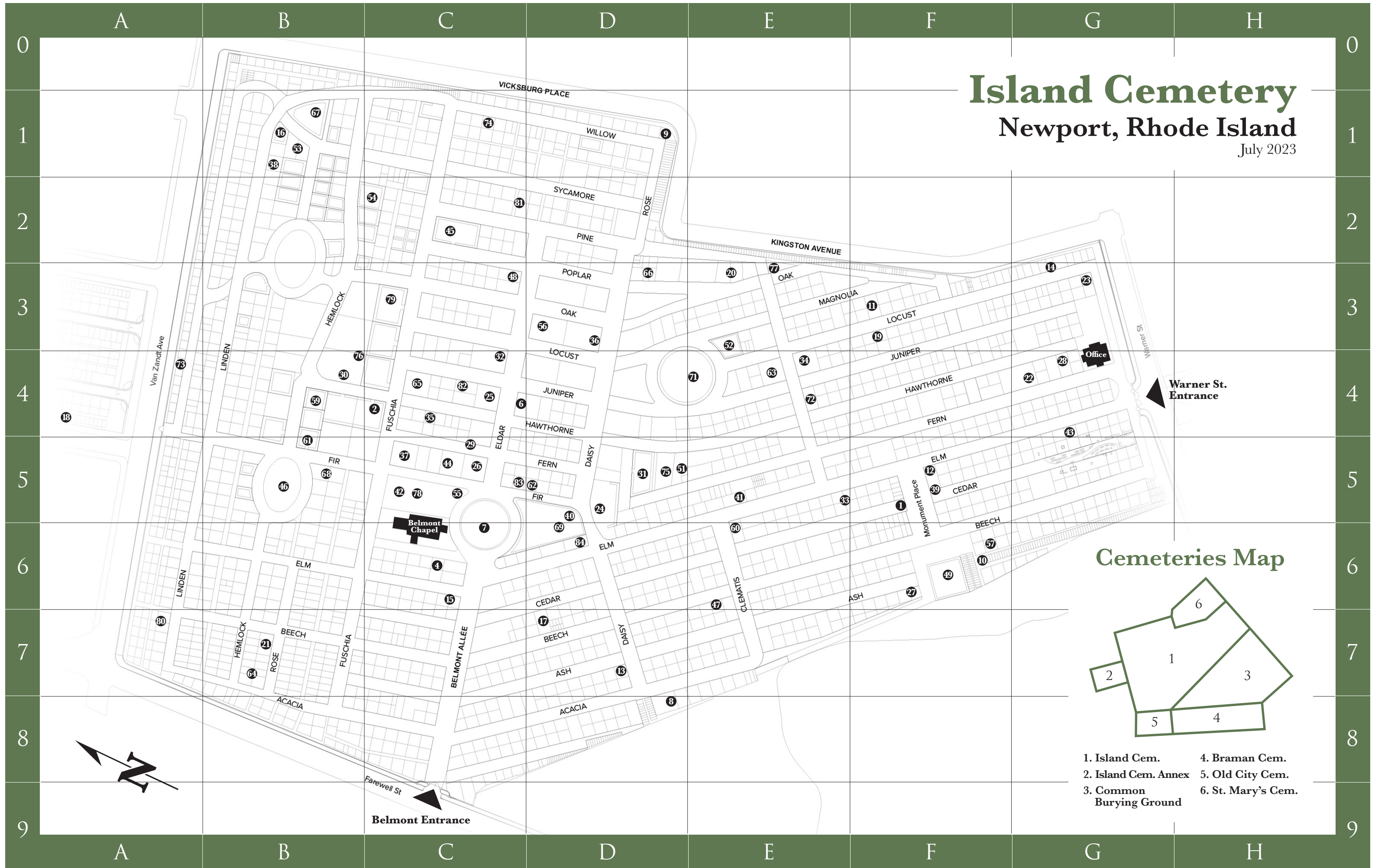

Cemeteries Map

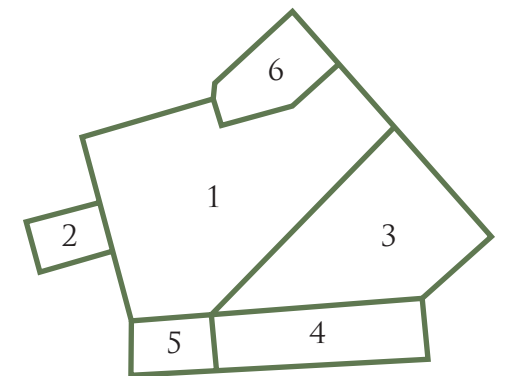

- 1. Island Cem.
- 2. Island Cem. Annex
- 3. Common Burying Ground
- 4. Braman Cem.
- 5. Old City Cem.
- 6. St. Mary's Cem.

Island Cemetery Notables

The numbers correspond to the visitors map of Island Cemetery on the previous page.

Section Key	Section Key	Section Key	Section Key
F5 1 Egypt Air Flight 990 (1999) 217 died in the crash	A4 18 Lt. Thomas Eadie (1887-1974) Medal of honor - in annex	C4 32 Frederick Rhinelander King (1887-1972) Architect, designed Seaman's Church Institute, Honeyman Hall	D5 51 Lt. Colonel John Hare Powel Jr. (1837-1892) Civil War veteran, active in Newport organizations
F3 2 Hugh Dudley Auchincloss, Jr. (1897-1976) Stockbroker and lawyer	F3 19 James C. Fludder (1847-1901) Architect, studied with Mason and Richardson, builder	C4 35 John G. Ladd (1807-1890) Architect, Littlefield house, 12 Catherine St.	E3 52 Frank Read rustic designed monument
C4 3 Janet Auchincloss (1907-1989) Mother of Jacqueline Kennedy	E3 20 Susan Braley Franklin (1868-1955) Teacher, historian	D3 36 Mary Lawton (1858-1896) Bronze angel monument	B1 53 Philip Mercer Rhinelander (1869-1839) Bishop of Pennsylvania, 1911-1925
C6 4 Joe Bailey (1802-1877) Property Developer	B7 21 Evanda Garnett (1896-1918) Royal flyer	C5 37 Henry Ledyard (1812-1880) Founder of Newport Hospital, board of Redwood Lib.	C2 54 George Lockhart Rives (1849-1917) US Assistant Secretary of State
C4 6 Seth Bateman (1772-1850) Bateman Hotel	G4 22 William Channing Gibbs (1787-1871) Governor	B1 38 Charles Howard Malcolm (1833-1899) DD great tomb	C5 55 Reginald Bulkeley Rives (1890-1957) Son-in-law to Whitney Warren
C6 7 Eleanor Robson Belmont (1879-1979) Actress, writer, founded the Met Opera Guild, married to August Belmont Jr.	G3 23 George Washington Greene (1811-1883) Historian	B1 38 Princess Alexandra Troubetzkoy Malcom (1910-1994) Artist, Russian Princess	D3 56 Charles Handy Russel (1796-1884) Merchant and Banker
C6 7 August Belmont (1813-1890) NY Financier, Belmont Chapel	D5 24 John NA Griswold (1822-1909) China Trade merchant, property developer in Newport	F5 39 Mark Malkovich III (1930-2010) Director of Newport Music Festival for 35 years	F6 57 Virginia Sampson (1908-2001) 70 years at I.C. as Superintendent
C6 7 Perry Belmont (1851-1947) Congressman from New York	D5 24 Jane Emmet Griswold (1832-1909) Intellectual, writer	D5 40 Henry Gurdon Marquand (1819-1902) Art collector, philanthropist, founder of the Metropolitan Museum of Art	B4 59 William Paine Sheffield Sr. (1820-1907) US Representative and Senator
C6 7 August Belmont Jr. (1853-1924) Took over from father running Belmont and Co. Financed the NYC subway and Cape Cod Canals	C4 25 J. Prescott Hall (1795-1862) Owned Malbone Estate, designed by Alexander Jackson Davis	E5 41 George Champlin Mason (1820-1894) Architect of Chepstow and 60 others with son, designed Belmont Chapel	E6 60 Major General Thomas West Sherman (1813-1879) US Army officer; Mexican-American War and Civil War
D8 8 Charles Bevins (1844-1925) Architect for wealthy Philadelphians, designed Horsehead	C5 26 Charles E. Hammett Jr. (1823-1902) Published Masons Reminiscences	C5 42 Marcella McCormack (1930-2010) Conservationist; Jane Picken's daughter	B5 61 John Jermain Slocum Jr. (1941-2017) Investment banker, founder of Slocum
D1 9 Gladys Carr Bolhouse (1899-1995)	F6 27 Major John Handy (1756-1828) Read the Declaration of Independence to citizens at Colony House in July 1776	G4 43 Alexander McGregor (1796-1870) Architect, builder of Armory, Perry Mill, Swanhurst, and Fort Adams	D5 62 Eileen Gillespie Slocum (1915-2008) Grande Dame of Newport Society
F6 10 Edith Bozyan (1907-1993) Artist	G4 28 John Alfred Hazard (1877-1920) Owned land, speculator	C5 44 Dudley Newton (1845-1907) Architect, trained with George Champlin Mason	E4 63 Isaac Spooner (1793-1868) George Champlin Mason Jr. designed the monument
F3 11 Seth Bradford (1801-1878) Architect for Chateau sur Mer	C5 29 Jane Picken Hoving (1910-1992) Singer and actress	C2 45 George H. Norman (1797-1867) Introduced national gas to Newport and installed waterworks throughout US	D3 36 Alfred Smith (1809-1886) Developed Kay/Catherine St.; with Bailey developed Ocean Drive
F5 12 Henry Bull (1816-1899) 1st President of Island Cemetery, Newport businessman	B4 30 Richard Morris Hunt (1827-1895) Premier architect in US, founder of AIA, designed 40 buildings in Newport	B5 46 Bud Palmer (1921-2013) Basketball player; sportscaster	B7 64 Clarence Stanhope (1852-1924) Amateur photographer of Newport
D7 13 Marion Carry (1905-1987) Artist and teacher at Newport Art Assoc.	B4 30 Richard Howland Hunt (1862-1931) Son of RMH, continued the business after father's death. Chinese Tea House	E6 47 Job Almy Peckham (1807-1877) Builder	C4 65 Major General Isaac Ingalls Stevens (1818-1862)
G3 14 Adeline Casswell White bronze monument	D5 31 Delancey Astor Kane (1844-1915) coaching	C3 48 Mildred Olive Bigelow Pell (1886-1980) Artist and author	D3 66 Maude Lyman Stevens (1869-1949) Historian on Newport and RI history, author
C6 15 John Rose Caswell (1834-1918) Caswell and Massey founder	C4 32 Edward King (1815-1875) China Trade merchant, property developer in Newport	C6 7 Commodore Matthew C. Perry (1794-1858) Opened trade to China	B1 67 Frank K. Sturgis (1847-1932) NYSE president, coaching, horse racing; SPCA; Casino, Redwood
B1 16 Theodore Montgomery Davis (1838-1915) Egyptologist	E5 33 Charles Bird King (1842-1901) Portrait artist of Native Americans	F6 49 Commodore Oliver H. Perry (1785-1819) Hero of Battle of 1813 Lake Erie	B5 68 Jeremiah Kirrian Sullivan (1857-1939) Contractor, benefactor
D7 17 George T. Downing (1819-1903) Abolitionist and anti-slavery activist, restaurateur	E4 34 Clarence King (1785-1901) Geologist, mountaineer with double life in NY	D6 69 Dr. Roderick Terry (1849-1933) Minister, President of NHS	C4 65 Major General Isaac Ingalls Stevens (1818-1862)
		D6 69 George Tiffany (1805-1886) Baltimore merchant related to Perry's; NY jewelry business	A7 80 Marcus Wheatland (1863-1934) First doctor to use x-ray, Newport City Council
			C2 81 William F. Wilbor (1836-1904) Builder Kay Catherine
			C4 82 Edwin Wilbur (1867-1943) Architect designed vault, firehouse, armory
			C5 83 Nina Maud Wilks (1869-1930) 20th Century Slate
			D6 84 Katherine Prescott Wormeley (1830-1908) Civil War volunteer nurse
			D6 69 Isabella Tiffany (1834-1912) Daughter of Matthew C. Perry
			D6 69 William Tiffany (1863-1898) Spanish American War Rough Rider
			C5 55 Gabriel Mead Tooker (1839-1905) NY society, the 400, memorial buried elsewhere
			E4 71 William R. Travers (1819-1887) Property developer
			E4 72 Dr. Henry E. Turner (1816-1897) Doctor in Newport for 60 years, civic-minded
			A4 73 Mathias Alonzo Van Horne (1871-1932) First African-American dentist in RI
			C1 74 Mahlon Van Horne (1840-1910) Pastor of Union Congregational Church, RI Legislature, consul to St. Thomas
			D5 75 Charles C. Van Zandt (1830-1894) Lt. Gov. and Gov. of RI, 1877-1880
			B4 76 Maud Wallach (1870-1954) Tennis Hall of Fame, 1958
			E3 77 Major General Gouverneur K. Warren (1830-1882) Civil War General, Gettysburg Hero
			C5 78 Whitney Warren (1864-1943) Architect designed Newport Country Club
			C3 79 George Peabody Wetmore (1846-1921) Governor, Senator, Chateau sur Mer
			C3 79 Edith Wetmore (1870-1966) 1st Pres. Preservation Soc., politically active
			C3 79 Maud Wetmore (1873-1951) Political leader